

1 Our Sincere Gratitude

Takeway® R2 Ranger Clampod Professional Edition is Takeway®'s another revolutionary breakthrough after R1 Ranger. The ultra-lightweight R2 Ranger Clampod is developed for the "outdoor enthusiast". The R2 Ranger weighs only 120 g and is convenient to use. It is suitable for consumer electronic devices such as action cams, smartphones, and tablets. Not only can it be clamped onto tubes, but it can also be fixed on flat surfaces. The R2 Ranger can be easily disassembled without tools and has a maximum load capacity of 3 kg (Static). The R2 Ranger will not get loose when it is used on the move; even dynamic moves in extreme sports will not affect its function. It can be enhanced by adding various matching accessories. This provides versatility based on the user's requirements. The R2 Ranger is portable and can be easily carried in the pocket. So enjoy every moment and explore new experience with Takeway® R2 Ranger Clampod Professional Edition!

2 Please test the relevant components and read the user guide before using this product

Before using this product on your consumer electronic devices, please check Takeway® R2 Ranger Clampod Profession Edition and its accessories for damage or deformation. If there are any defects, please contact the salesperson to exchange your product. A properly functioning product prevents damage to your consumer electronic devices or personal injury caused by the faulty product. Takeway® takes no responsibility and assumes no liability for the loss or inconvenience caused by the user's own negligence.

3 List of Components

*Note: Optional accessory

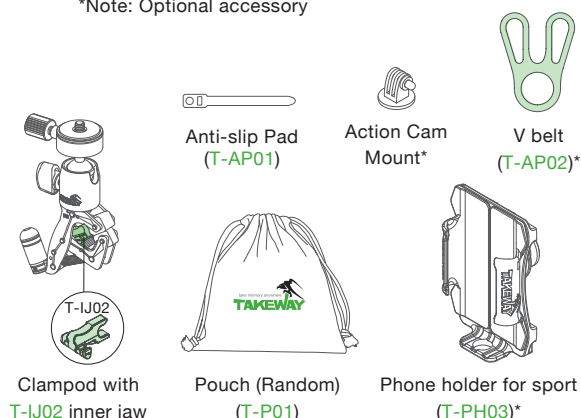

4 Operating Instructions

4-1: When clamping the R2 Ranger on a smooth cylindrical surface, place the anti-slip pad between the surface and the clampod to increase grip.

4-2: The body of the clamp is made of aluminum alloys and in general free from rust. However, to avoid the product being damaged, do not keep the product in a humid environment over a long period of time.

4-3: Do not use or store the product near heat or an open flame, which will damage the plastic components. If the product has not been used for a long time, please check the components and make sure they function properly, before mounting any devices. This might prevent the device from getting loose and falling during mounting.

4-4: After the product is assembled, please first place it on a flat surface and check for its stability. When using this product in a standing position and mounting the device on the clampod, do not remove your hands from your electronic device until you are sure that both the device and the clampod are securely fixed. Make sure that the clampod stands firmly on the surface before shooting so that your electronic device will not be damaged due to the fall of the clampod.

4-5: Please follow the installation instructions below when using this product. First, clamp and fix the R2 Ranger on a chosen object. Then use the attached quick release clip to mount your electronic device. During the process, Make sure that your electronic device is securely mounted and the clampod grips tightly on the clamped object to prevent your device from falling and getting damaged.

4-6: When attaching the quick release clip to an electronic device or accessory, make sure that the quick release clip is screwed in tightly to prevent it from getting loose and falling.

4-7: When using or storing the clampod, make sure that the jaws do not clasp something sharp as doing so may damage the jaws.

5 List of Components

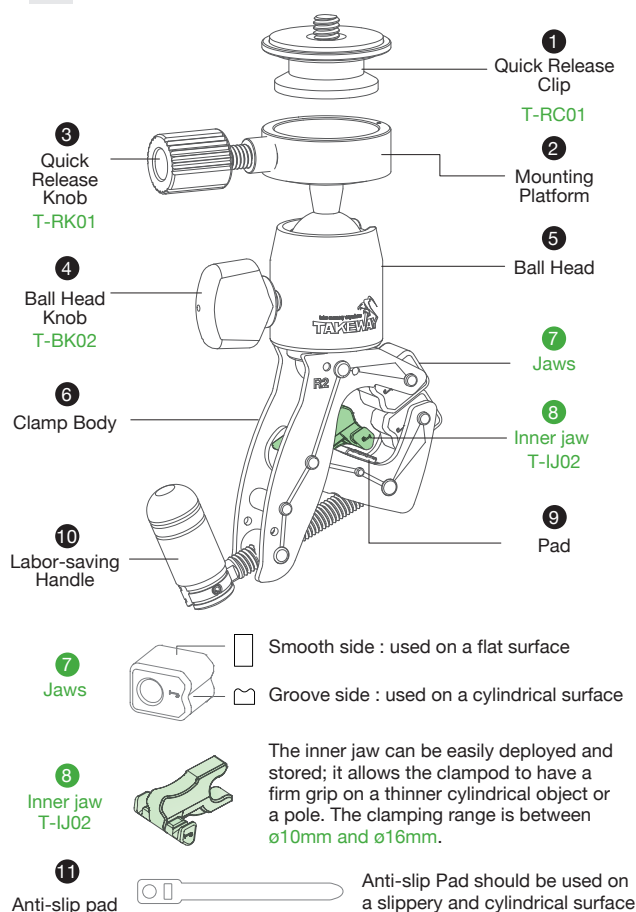

6 Assembly and Use

6-1: Anti-slip pad assembly, disassembly, and storage

Wrap the ① Anti-slip Pad around a smooth cylindrical object and then clamp the R2 Ranger to increase stability and to avoid sliding of the clampod. The pad can be stored between the quick release knob and the mounting platform to prevent loss.

6-1-1: Storing the anti-slip pad

As the figure shows, store ① Anti-slip Pad between ③ Quick Release Knob and ② Mounting Platform.

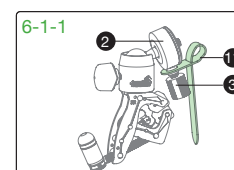

6-1-2: Using the anti-slip pad

As Figure 6-1-2 shows, wrap ① Anti-slip Pad around the cylindrical object. Then use ⑦ Jaws to clamp the R2 Ranger onto the anti-slip pad surface to increase grip.

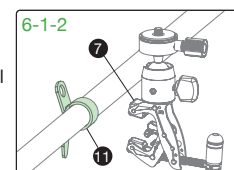

6-2: Function of the inner jaw

Using an inner jaw can make clamping on small tubes more convenient and secure. The inner jaw is made of glass-fiber reinforced nylon and of high strength. All R2 are installed with an inner jaw during the manufacturing process; please do not remove the inner jaw from the clampod unless necessary.

6-2-1: Using the inner jaw

Move the inner jaw downward from its stationed position. It becomes the third point between the clamping jaw tips and can further strengthen the stability of clamping on cylindrical objects. After clamping the R2 Ranger on an object, gently shake the clampod to make sure that the clampod firmly grips the clamped object; this check could prevent the clampod from getting loose and falling.

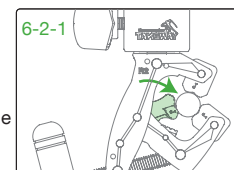

6-2-2: Clamping instruction

Clamp onto a small cylindrical object
Clamping range: Ø 10-16mm
For cylindrical objects Ø10 – Ø16 mm, the inner jaw should be pushed out. Then use the jaws and the inner jaw to make a "3 J-point clamp".

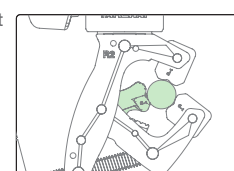

Clamp onto a large cylindrical object
For cylindrical objects Ø17~Ø32mm, the inner jaw should be in its stationed position. Use only the clamp body and make sure that the clamped object is completely wrapped inside the clamp body.

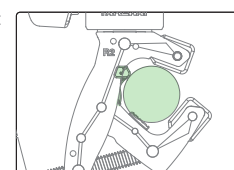

Clamp onto a board/plate
Clamping range: 1-32mm
Use only the jaws for clamping

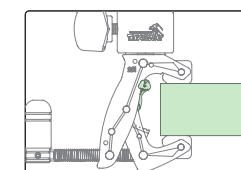

6-3: Instructions for Clamping

To clamp properly onto a thin cylindrical object, please refer to 6-2-1 'Using the inner jaw'. To clamp properly onto a smooth cylindrical surface, please refer to 6-1-2 'Using the anti-slip pad'.

6-3-1: Clamp and secure the clampod onto a chosen object. As shown in the figure, ⑩ Labor-saving Handle is bendable and provides versatile application, even in a limited space. Clamping is faster and more convenient and at the same time needs less effort thanks to the design of the handle.

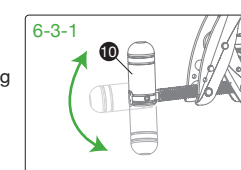

6-3-2: Clamp the R2 Ranger onto a chosen surface. Shake gently to make sure that it is securely fixed on the clamped object to prevent the set from getting loose and falling.

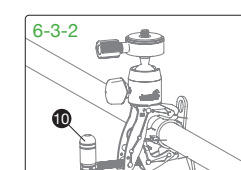

6-4: Mounting and Using A Digital Camera

6-4-1: Release ③ Quick Release Knob and remove ① Quick Release Clip. Screw in the quick release clip on your digital camera with a coin or a flathead screwdriver. Please make sure that the quick release clip is screwed in tightly so that the camera does not get loose.

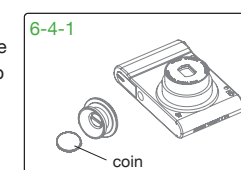

6-4-2: Clamp the R2 Ranger
Clamp the R2 Ranger onto a desired object and location and then shake the clampod gently to make sure that it is securely fixed to prevent the clampod from getting loose and falling.

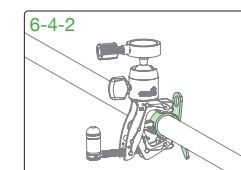

6-4-3: Mount the camera with ① Quick Release Clip ready in 6-4-1 on ② Mounting platform, and screw in ③ Quick Release Knob. Adjust the camera to a desired position and then start your photo shooting. When shooting, please use the ④ Ball Head Knob to pan the camera.

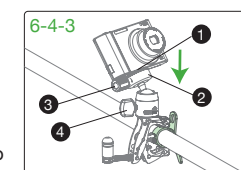

7 Mounting and Using An Action Camera

7-1: Mounting an action camera

The referred action cam mount in the assembly instructions is a standard accessory for the R2 Ranger. We also recommend purchasing additional T-RC03 Action Camera Quick Release Clip for additional convenience for use.

7-1-1: Clamping the R2 Ranger
Clamp the R2 Ranger onto a desired object and location. Please refer to 6-3 Instructions for clamping; release ③ Quick Release Knob and remove ① Quick release clip.

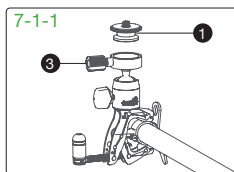

7-1-2: Screw in ① Quick Release Clip to the ④ action cam mount with a coin and then mount the action camera housing case onto the set. Make sure that the whole set is securely fixed to prevent the action camera from getting loose and falling.

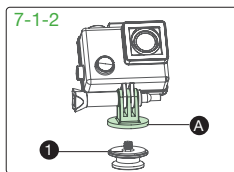

7-1-3: Mount the action camera with ① Quick Release Clip on ② Mounting Platform. Then screw in ③ Quick Release Knob. Adjust the action camera to a desired position by using the ball head and then start shooting.

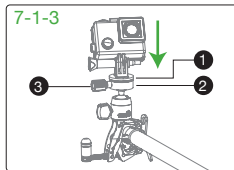

8 T-PH03 Phone Holder for Sport List of Components

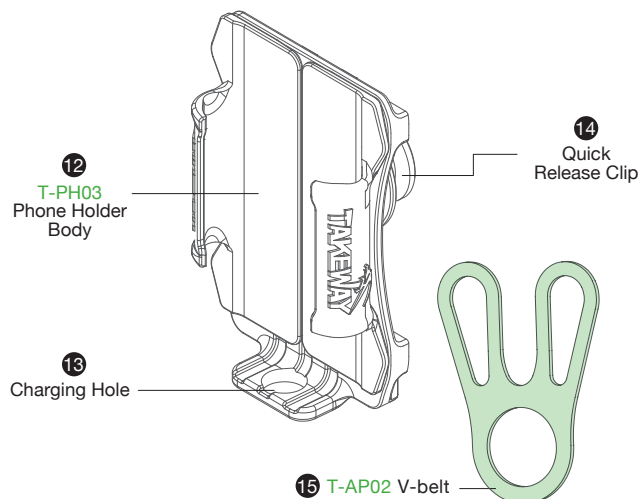

8-1: Mounting and Operating

8-1-1: Push ④ the mounting plates slightly outward and insert the phone from the top to the bottom as shown in Figure 8-1-1.

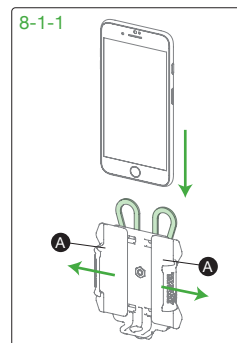

8-1-2: Put ⑮ V-belt into the groove ⑤ on ⑭ Quick Release Clip. Pull the ears of ⑮ V-belt to encircle both top edges of the phone.

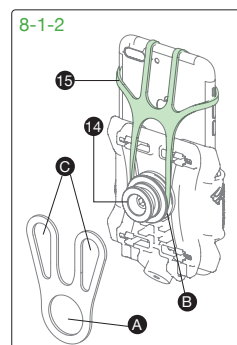

8-1-3: Clamp the R2 Ranger onto a chosen object and shake gently to make sure that it is securely fixed on the object to prevent the phone from getting loose and falling.

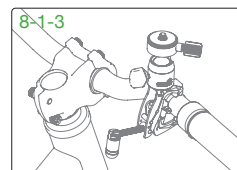

8-1-4: Release ③ Quick Release Knob and remove ① Quick Release Clip. Mount the complete set in 8-1-2 onto ② Mounting platform. Screw in ④ Quick Release Knob and make sure that the whole mounted set is securely fixed on the clamped object. Adjust the phone to a desired position and then start using your phone. When using, use ④ Ball Head Knob to adjust the angle of the phone.

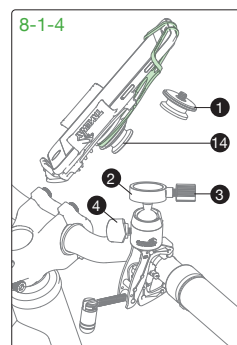

8-1-5: The charging hole ⑬ is for your power cable or headphone wire.

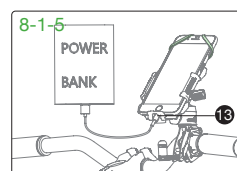

8-1-6: The installation is complete.

9 Safety Precaution

- 9-1: Please follow the instruction in this user guide. Takeway® takes no responsibility for any man-made damage caused by improper installation and operation.
- 9-2: Please do not move your hands away from your device and the clampod before it is certain that the set is firmly clamped on the selected object, or your electronic device might fall and get damaged.
- 9-3: The clampod has excellent clamping force. To prevent any damage on the clamped object, please do not over tighten the clamp body.
- 9-4: Do not wipe the clampod and accessories with any volatile solvents (for example, kerosene and organic solvents such as paint thinners).
- 9-5: If the product is damaged or deformed due to falls or impact, please stop using the product immediately. The damage and deformation might compromise the clamping force and the mounted device could fall and get damaged.
- 9-6: A child aged under 12 operating the product should be accompanied by an adult.
- 9-7: For your safety, please do not use any electronic devices while driving a vehicle or riding a motorbike.

10 Specifications of The Product

Model : R2 Ranger Professional Edition

Size: 10 x 7 x 3.2cm

Weight: 120g

Materials: Aluminum alloys for aerospace applications, Glass-fiber reinforced nylon

Screw of the quick release clip: 1/4"

Clamping range: Ø10 - Ø32 mm or flat surface 5 - 32 mm

Clamp load capacity (Dynamic): 300g

Clamp load capacity (Static): 3kg

Model : T-PH03 Phone Holder for Sport (Optional accessory)

Size: 11 x 7 x 4.8 cm

Weight: 80g

Materials: Plastic, Aluminum alloy, Silicone (V-belt)

Available size: Maximum size 15.8 x 9 x 1.3 cm

(Suitable for a smartphone with a screen size from 4" to 6")

Clamp load capacity (Dynamic): 300g

Made in Taiwan

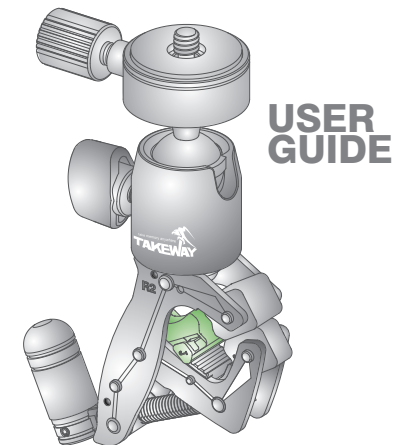

Before using the product for the first time, please carefully read through the user guide.

Please also make sure that you fully understand the content of the user guide and correctly use this product following the instructions.

More user guides in different languages
<https://www.takewayglobal.com/download.htm>



All information described in this user guide is based on the test standard of Takeway®. We apologize for the inconvenience caused if there are any errors.
The design and specifications of this product are subject to change without notice.

Copyright: All Rights Reserved

EHOMA INDUSTRIAL CORPORATION

TEL: +886-4-2406 5031
info@takeway.tw
www.takewayglobal.com